

GANCI

CODICE	DESCRIZIONE	L	S	MATERIALE
JR08067002	Gancio "S" aperto	40	4	Zincato

- Ganci ad "S" di altre misure disponibili a pagina Pag.08-52

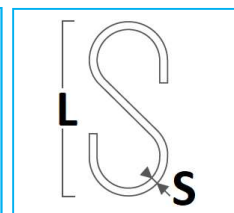

CODICE	DESCRIZIONE	L	S	MATERIALE
JR18023002	Gancio "S" chiuso	50	4	Zincato

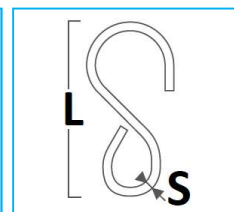

CODICE	DESCRIZIONE	L	S	MATERIALE
JR18023003	Gancio "S" girato	45	4	Zincato

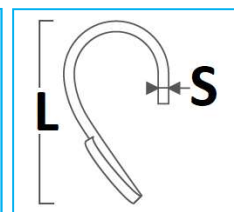
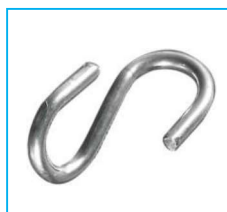

CODICE	DESCRIZIONE	A	L	M	MATERIALE
JR18024001	Gancio sponda	20	72	20	Zincato
JR18024002	Gancio sponda	20	55	Zincato	

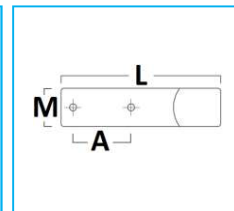

CODICE	DESCRIZIONE	A	L	M	MATERIALE
JR18025001	Gancio a becco	40	59	21	Zincato

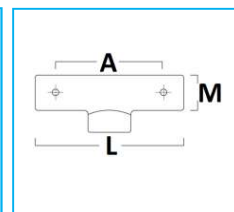

CODICE	DESCRIZIONE	L	M	COLORE	MATERIALE
JR18026001	Gancio sponda "S"	41	25	Bianco	Fibra di vetro
JR18026002	Gancio sponda "S"	41	25	Grigio	Fibra di vetro
JR18026003	Gancio sponda "S"	41	25	Nero	Fibra di vetro
JR18026004	Gancio sponda "S"	41	37	Bianco	Nylon
JR18026005	Gancio sponda "S"	41	37	Nero	Nylon

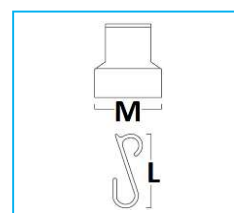

NB: LE MISURE SONO IN "mm".

GANCI

CODICE	DESCRIZIONE	L	M	MATERIALE
JR18027001	Gancio doppio - Nero	50	20	Nylon
JR18027002	Gancio doppio - Bianco	50	20	Nylon

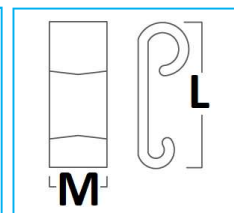

CODICE	DESCRIZIONE	D	MATERIALE
JR18028001	Gancio tondo - Nero	50	Nylon
JR18028002	Gancio tondo - Bianco	50	Nylon

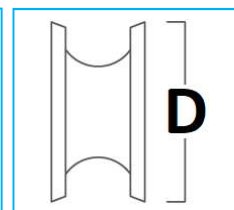
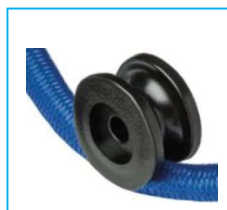

CODICE	DESCRIZIONE	A	B	C	MATERIALE
JR18029001	Bottone tondo	40	5	21	Nylon

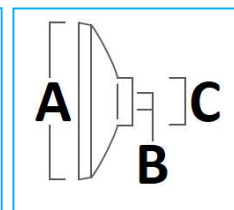

CODICE	DESCRIZIONE	L	MATERIALE
JR18030001	Moschettone	70	Nylon

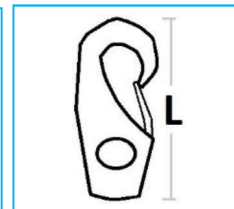

CODICE	DESCRIZIONE	A	L	M	MATERIALE
JR18031001	Gan.Zig Zag aperto	20	60	22	Nylon

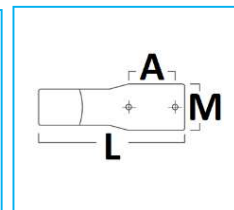

CODICE	DESCRIZIONE	A	L	M	MATERIALE
JR18031002	Gan.Zig Zag aperto	20	63	20	Nylon

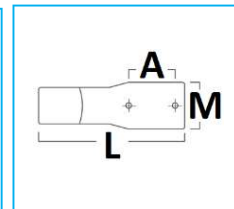

CODICE	DESCRIZIONE	L	M	MATERIALE
JR18031003	Gan.Zig Zag doppio	60	35	Nylon

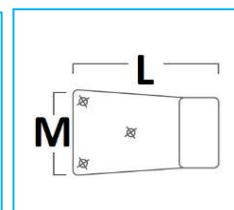

NB: LE MISURE SONO IN "mm".

GANCI

CODICE	DESCRIZIONE	A	L	M	MATERIALE
JR18032001	Piastrina rivetto incorporato	20	36	16	Nylon

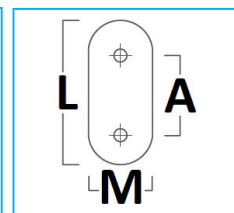

CODICE	DESCRIZIONE	A	L	M	MATERIALE
JR18032002	Piastrina rivetto non incorporato	20	36	16	Nylon

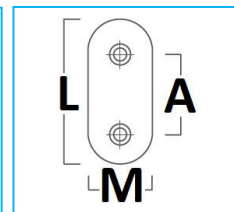

CODICE	DESCRIZIONE	D	d	H	MATERIALE
JR18032003	Rivetti 4,5x9,2	9,7	4,5	9,2	Ottone - Nichel

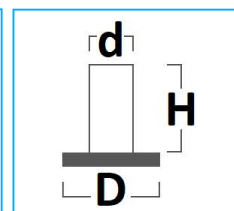

CODICE	DESCRIZIONE	A	L	M	MATERIALE
JR18033001	Piast. triangolare rivetto incorporato	20	30	33	Nylon

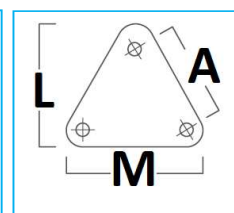

CODICE	DESCRIZIONE	A	L	M	MATERIALE
JR18033002	Piast. triangolare riv.non incorpor.	20	30	33	Nylon

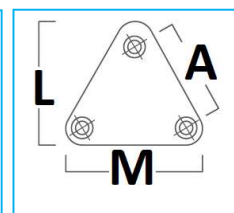

CODICE	DESCRIZIONE	D	d	H	MATERIALE
JR18032003	Rivetti 4,5x9,2	9,7	4,5	9,2	Ottone - Nichel

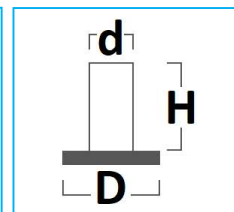

CODICE	DESCRIZIONE	D	d	H	MATERIALE
JR18034001	Gomma rotonda	22	4,5	2	Nylon

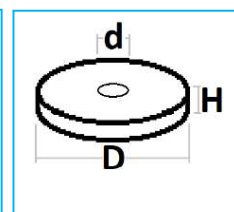

NB: LE MISURE SONO IN "mm".

GANCI

CODICE	DESCRIZIONE	A	L	M	MATERIALE
JR18035001	Gancio cobra piccolo	26	45	38	Nylon

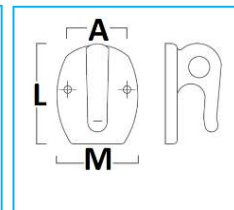

CODICE	DESCRIZIONE	A	L	M	MATERIALE
JR18035002	Gancio cobra picc. senza passante	26	45	38	Nylon

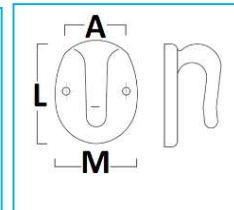

CODICE	DESCRIZIONE	A	L	M	MATERIALE
JR18036001	Gancio cobra medio	30	55	45	Nylon - Bianco
JR18036002		30	55	45	Nylon - Grigio
JR18036003	misura special	36	57	49	Nylon - Bianco

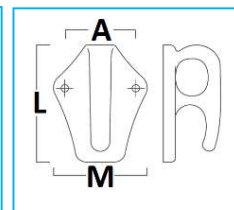

CODICE	DESCRIZIONE	A	L	M	COLORE	MATERIALE
JR18037001	Gancio	30	55	47	Bianco	Nylon
JR18037002	cobra	30	55	47	Grigio	Nylon
JR18037003	grande	30	55	47	Nero	Nylon

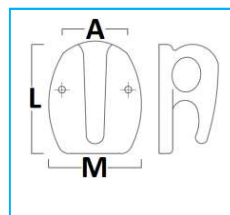

CODICE	DESCRIZIONE	∅	L	MATERIALE
JR18038001	Gancio cestello	8	62	Zincato
JR18038002	Gancio cestello ricoperto	8	72	Zincato
JR18038003	Ranella gancio cestello	8		Zincato

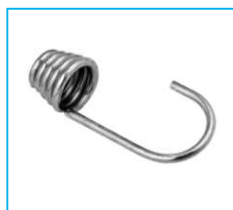

NB: LE MISURE SONO IN "mm".

GANCI

CODICE	DESCRIZIONE	COLORE	MATERIALE
JR18039001	Gancio	Rosso	Nylon
JR18039002	cestello	Giallo	Nylon
JR18039003	con sicura	Bianco	Nylon

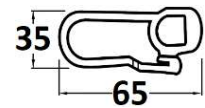

CODICE	DESCRIZIONE	L	H	MATERIALE
JR18040001	Capocorda Ø6	6	58	Zincato
JR18040002	Occhiello ovale Ø6			Ottone
JR18040004	Capocorda Ø8	8	70	Zincato
JR18040005	Occhiello ovale Ø8			Ottone
JR18040003	Chiodo capicorda Ø6 - Ø8	18		Zincato

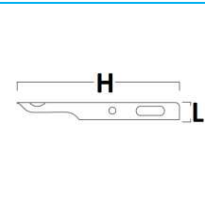

CODICE	DESCRIZIONE	L	MATERIALE
JR18041001	Punti P7	20,6	Zincato
JR18041002	Punti P7	20,6	Acciaio inox

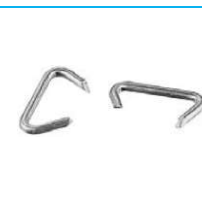

CODICE	DESCRIZIONE	L	H	MATERIALE
JR18042001	Fascetta per corda elastica Ø6-8	12	10	Zincato

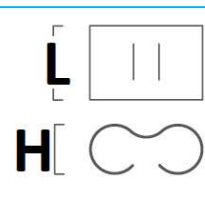

CODICE	DESCRIZIONE	L	H	MATERIALE
JR18042002	Fascetta per corda elastica lunga Ø6-8	25	10	Zincato

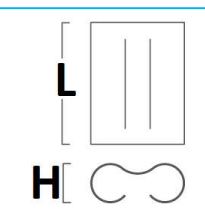

CODICE	DESCRIZIONE	D	d	H	MATERIALE
JR18043001	Rivetto testa e gambo	13	3,2	11,8	Zincato

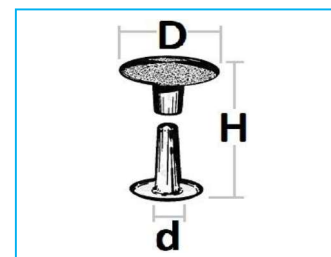

NB: LE MISURE SONO IN "mm".

GANCI

CODICE	DESCRIZIONE	L	MATERIALE
JR18044001	Molla simplex	40	Zincato
JR18044002	Molla simplex	50	Zincato
JR18044003	Molla simplex	60	Zincato
JR18044004	Molla simplex	70	Zincato
JR18044005	Molla simplex	80	Zincato
JR18044006	Molla simplex	90	Zincato
JR18044007	Molla simplex	100	Zincato

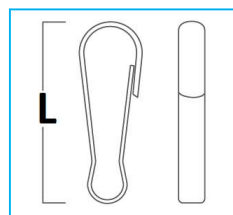

CODICE	DESCRIZIONE	S	L	MATERIALE
JR18045001	Moschettone	4	40	Zincato
JR08065001	Moschettone	5	50	Zincato
JR08065002	Moschettone	6	60	Zincato
JR08065003	Moschettone	7	70	Zincato
JR08065004	Moschettone	8	80	Zincato
JR08065005	Moschettone	9	90	Zincato
JR08065006	Moschettone	10	100	Zincato
JR18045008	Moschettone	4	40	Inox
JR18045009	Moschettone	5	50	Inox
JR18045010	Moschettone	6	60	Inox
JR18045011	Moschettone	7	70	Inox
JR18045012	Moschettone	8	80	Inox
JR18045013	Moschettone	9	90	Inox
JR18045014	Moschettone	10	100	Inox

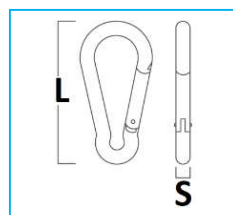
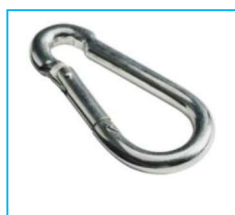

NB: LE MISURE SONO IN "mm".

GANCI

CODICE	DESCRIZIONE	A	L	M	MATERIALE
JR18031004	Gancio Zig Zag chiuso	20	63	20	Nylon

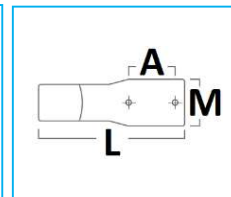

NB: LE MISURE SONO IN "mm".

JOLLY RICAMBI